

SAVED: 8/16/2019 11:00 AM SHEATH, PLOTTED: 8/16/2019 2:06 PM SAM R. HEATH
 \\Willis\Projects\2016\416076-MCCSD-PER Dwg\416076-CIVIL.dwg

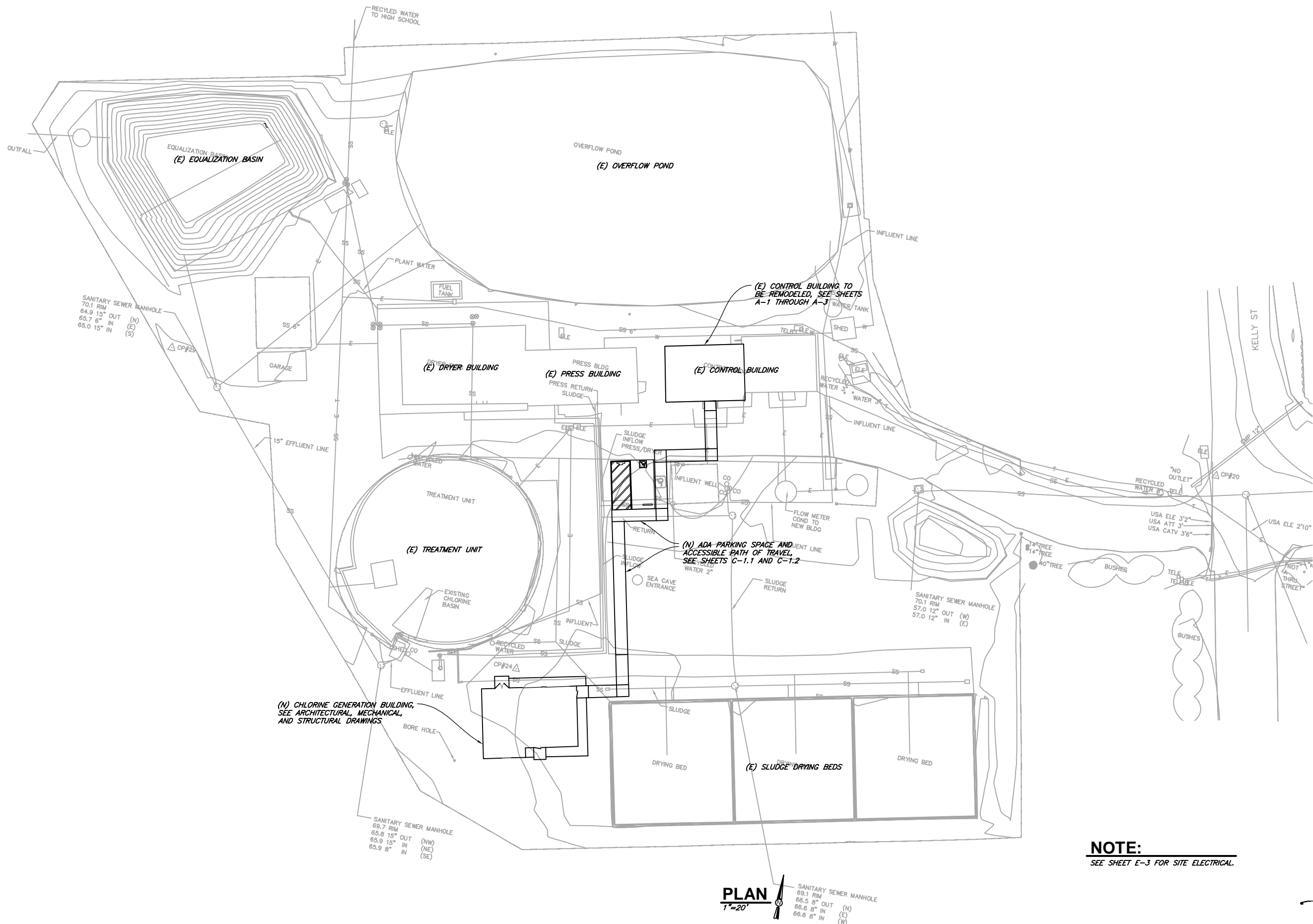

NOTE:
 SEE SHEET E-3 FOR SITE ELECTRICAL.

PLAN
 1"=20'

SANITARY SEWER MANHOLE
 69.1 RIM
 66.5 8" OUT (N)
 66.6 8" IN (E)
 66.6 8" IN (W)



VERIFY SCALES
 BAR IS ONE INCH ON ORIGINAL DRAWING
 IF NOT ONE INCH ON THIS SHEET, VERIFY SCALES ACCORDINGLY

SRH
 CONSULTING ENGINEERS & GEOLOGISTS, INC.
 WWW.SRH-ENGR.COM
 335 S. MAIN ST.
 WILLITS, CA. 95490
 707-459-4518

DESIGN	SRH	BY
DR	SRH	
CHK	JSO	
APVD		
DATE	08/09/2019	CHANGE ORDER #1
NO.	2	REVISION

PROJECT	MENDOCINO CITY CSD PLANT IMPROVEMENTS AND RECYCLED WATER SYSTEM MENDOCINO, CALIFORNIA
SHEET	C-1
DATE	03/2019
PROJ. NO.	416076.500

8/22/19